

Installing Spars in Foam Wing Cores

1. Prepare the Slotting Tool

- Select a **flat, hard balsa piece** (at least 7" long, same width as the spar).
- **Bevel the edges** at 15 degrees.
- Glue **120-grit sandpaper** to the beveled edge.
- Mark the **depth line** on the side of the tool to match the spar size.

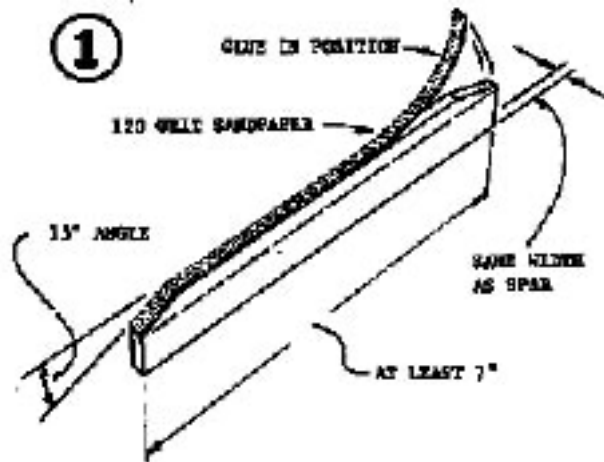

2. Cut the Spar Slot

- Lay the **wing core flat** on a table and mark the spar slot location.

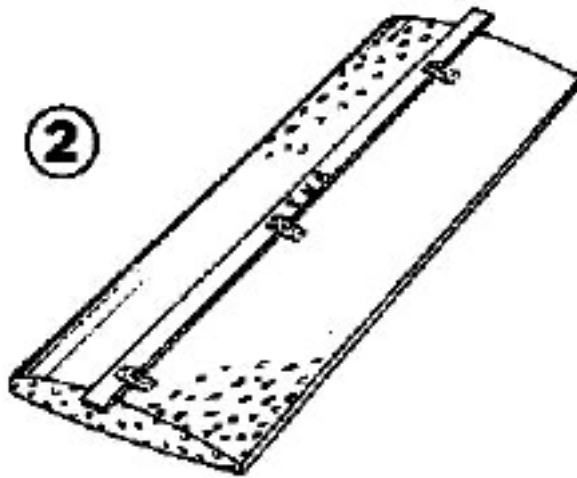

- Hold a ruler firmly in place and **run the slotting tool back and forth** until the proper depth is reached.

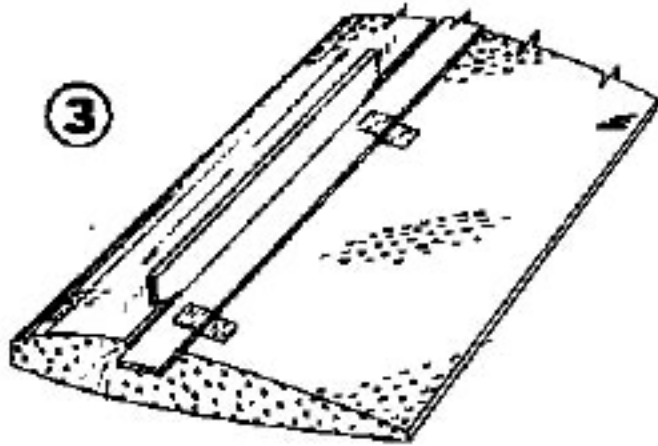

3. Install the Spar

- Place the **wing** in its **foam saddle** for support.

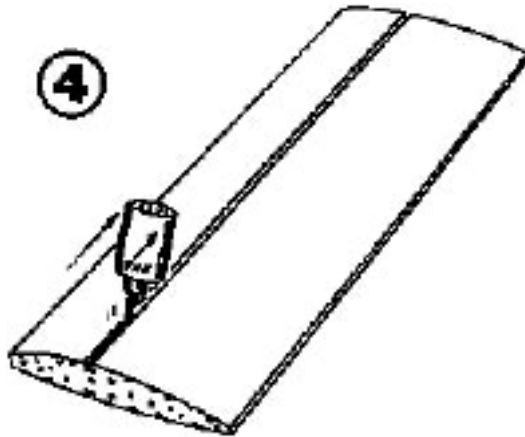

- Apply a **bead of white glue** in the slot and press the **spar into position**.
- Cover the wing with **wax paper** to prevent sticking.
- Place the **top foam saddle** back on, add a **flat board with weights** to keep the spar straight.
- Both spars can be installed at once but protect the **bottom core with wax paper**.